

LABORATORY FIRE SAFETY:

Code Red Response, Fire Extinguishers, Pull Stations



4867 SUNSET BOULEVARD – MAIN LABORATORY

EMERGENCY RESPONSE CODE FOR A FIRE



CODE RED

3-3000



FIRE EXTINGUISHERS

PULL the pin

AIM at the base of the fire

SQUEEZE the handle

SWEEP from side to side



LOCATION OF FIRE EXTINGUISHERS

4867 MEDICAL CENTER

6

WITHIN THE 4867 MAIN LAB

+

2

JUST OUTSIDE THE ENTRANCES

8

TOTAL FIRE EXTINGUISHERS



WALL MOUNTED

INSIDE A WALL CABINET

LOOK FOR OVERHEAD SIGNS



LOCATION OF FIRE EXTINGUISHERS – 4867 MEDICAL CENTER

1. Next to SW side door (Admin Coordinator Desk)

2. Outside the staff entrance door to the right within the wall compartment
3. Employee RESTROOM – outside of the restroom toward back exit
4. Core Lab, on the side of the Routine Pnuematic Tube system facing Hematology
5. Behind the printer located next to Chemical Spill kit
6. Inside the EMPLOYEE LOUNGE
7. OUTSIDE MAIN ENTRANCE (Double doors leading to Flow Cytometry)
8. CONTROLLER AREA - Phlebotomy staging area



LOCATION OF FIRE EXTINGUISHERS – 4867 MEDICAL CENTER

1. Next to SW side door (Admin Coordinator Desk)
2. **Outside the staff entrance door to the right within the wall compartment**
3. Employee RESTROOM – outside of the restroom
4. Core Lab, on the side of the Routine Pnuematic Tube system facing Hematology
5. Behind the printer located next to Chemical Spill kit
6. Inside the EMPLOYEE LOUNGE
7. OUTSIDE MAIN ENTRANCE (Double doors leading to Flow Cytometry)
8. CONTROLLER AREA - Phlebotomy staging area



LOCATION OF FIRE EXTINGUISHERS – MAIN LAB 4867 MEDICAL CENTER

1. Next to SW side door (Admin Coordinator Desk)
2. Outside the staff entrance door to the right within the wall compartment
3. **Employee RESTROOM – outside of the restroom toward back exit**
4. Core Lab, on the side of the Routine Pnuematic Tube system facing Hematology
5. Behind the **printer** located next to Chemical Spill kit
6. Inside the EMPLOYEE LOUNGE
7. OUTSIDE MAIN ENTRANCE (Double doors leading to Flow Cytometry)
8. CONTROLLER AREA - Phlebotomy staging area



LOCATION OF FIRE EXTINGUISHERS – MAIN LAB 4867 MEDICAL CENTER

1. Next to SW side door (Admin Coordinator Desk)
2. Outside the staff entrance door to the right within the wall compartment
3. Employee RESTROOM – outside of the restroom toward back exit
4. **Core Lab, on the side of the Routine Pnuematic Tube system facing Hematology**
5. Behind the printer located next to Chemical Spill kit
6. Inside the EMPLOYEE LOUNGE
7. OUTSIDE MAIN ENTRANCE (Double doors leading to Flow Cytometry)
8. CONTROLLER AREA - Phlebotomy staging area



LOCATION OF FIRE EXTINGUISHERS – 4867 MEDICAL CENTER

1. Next to SW side door (Admin Coordinator Desk)
2. Outside the staff entrance door to the right within the wall compartment
3. Employee RESTROOM – outside of the restroom toward back exit
4. Core Lab, on the side of the Routine Pnuematic Tube system facing Hematology
5. **Behind the PRINTER located next to Chemical Spill kit**
6. Inside the EMPLOYEE LOUNGE
7. OUTSIDE MAIN ENTRANCE (Double doors leading to Flow Cytometry)
8. CONTROLLER AREA - Phlebotomy staging area

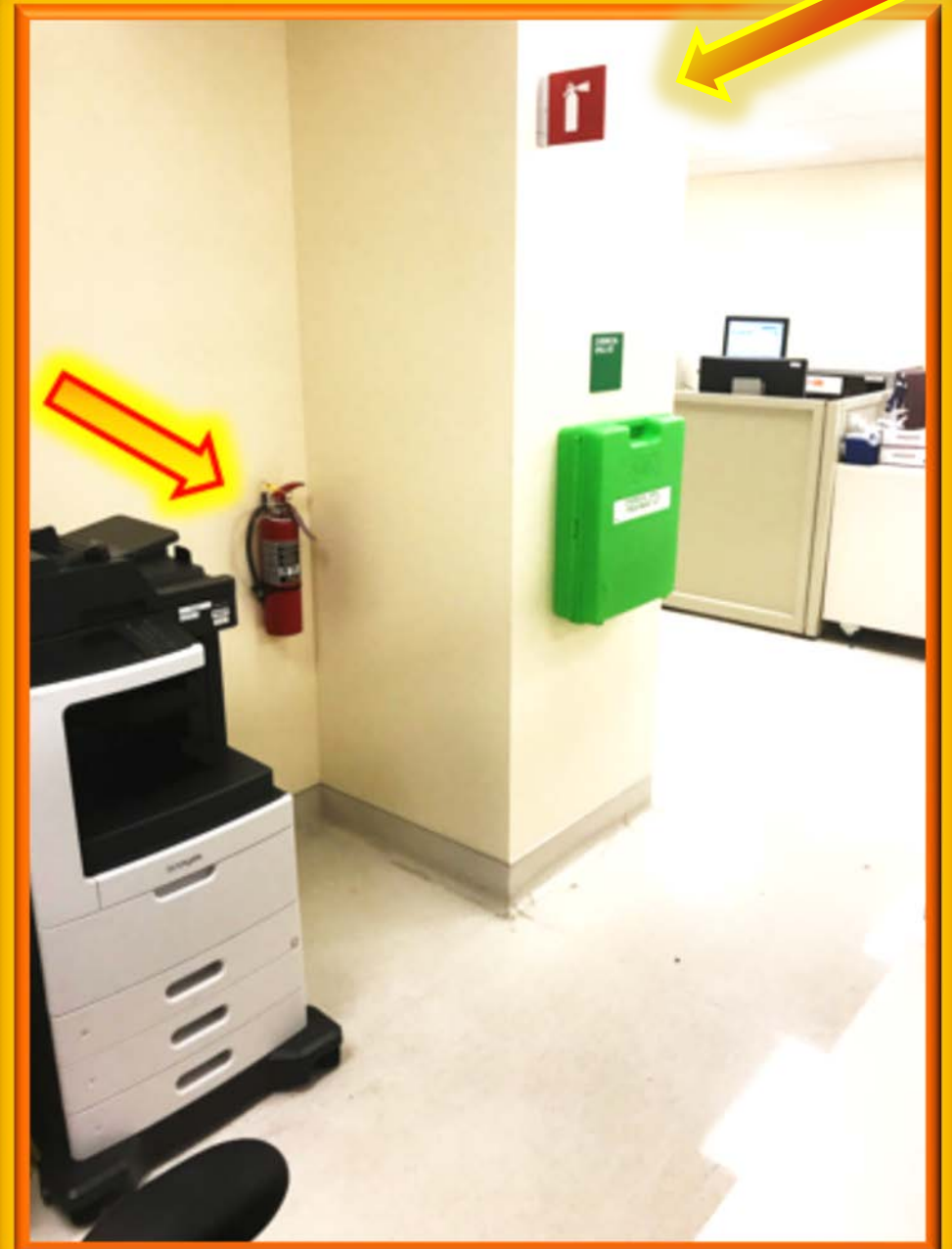

LOCATION OF FIRE EXTINGUISHERS – MAIN LAB 4867 MEDICAL CENTER

1. Next to SW side door (Admin Coordinator Desk)
2. Outside the staff entrance door to the right within the wall compartment
3. Employee RESTROOM – outside of the restroom toward back exit
4. Core Lab, on the side of the Routine Pnuematic Tube system facing Hematology
5. Behind the PRINTER located next to Chemical Spill kit
- 6. Inside the EMPLOYEE LOUNGE**
7. OUTSIDE MAIN ENTRANCE (Double doors leading to Flow Cytometry)
8. CONTROLLER AREA - Phlebotomy staging area



LOCATION OF FIRE EXTINGUISHERS – MAIN LAB 4867 MEDICAL CENTER

1. Next to SW side door (Admin Coordinator Desk)
2. Outside the staff entrance door to the right within the wall compartment
3. Employee RESTROOM – outside of the restroom toward back exit
4. Core Lab, on the side of the Routine Pnuematic Tube system facing Hematology
5. Behind the PRINTER located next to Chemical Spill kit
6. Inside the EMPLOYEE LOUNGE
7. **OUTSIDE MAIN ENTRANCE** (Double doors leading to Flow Cytometry)
8. CONTROLLER AREA - Phlebotomy staging area



LOCATION OF FIRE EXTINGUISHERS – MAIN LAB 4867 MEDICAL CENTER

1. Next to SW side door (Admin Coordinator Desk)
2. Outside the staff entrance door to the right within the wall compartment
3. Employee RESTROOM – outside of the restroom toward back exit
4. Core Lab, on the side of the Routine Pnuematic Tube system facing Hematology
5. Behind the PRINTER located next to Chemical Spill kit
6. Inside the EMPLOYEE LOUNGE
7. OUTSIDE MAIN ENTRANCE (Double doors leading to Flow Cytometry)
8. **CONTROLLER AREA - Phlebotomy staging area**



FIRE PULL STATIONS

1



**EXIT from LAB outside
"Stairwell 7"**



2



**Next to Staff Lockers outside
restrooms**