



# SCC-LIS\_TIP OF THE WEEK

MODULE: SoftLab/SoftMic/SoftBank	SOFTWARE VERSION: 4.04/4.08
TOPIC: SingleSign Server	ISSUE DATE: 17Nov2016
DISTRIBUTION: End Users_All	PAGE: 1 of 1
ISSUED BY: M-L Dufresne, Territorial LIS Administrator	

## TOPIC/QUESTION:

What is the SCC Single Sign Server and why should I care?

## ANSWER/TIP:

The "SingleSign Server" (SSOS) is the yellow padlock icon you will see on the toolbar at the bottom right hand side of your screen.



Its purpose is to remember your login and password so that if you are already logged into one LIS application (i.e SoftLab) then you can bridge to other Soft applications (i.e SoftBank, SoftTQC) without having to log-on to each application separately.

Occasionally, such as during a power blip or when a user closes out of the application using the "X" instead of the log-off button, the SSOS memory does not "clear" properly.

When the cache memory does not clear properly, it becomes "stuck" and you may find that the system is automatically logging you in under another user or not letting you log yourself out.

In this case you will need to manually clear the cache of the single sign server in order to get logged on under the proper credentials.

**To Clear Cache:** Right-Click the  Icon and "Clear Cache".

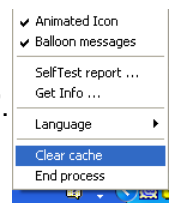

Icon will turn into a red garbage 

***\*\*It is each of your responsibility to ensure you are logged off properly (do not "x" out), and ideally, clear cache everytime you are leaving a terminal. Use the SCC application only when logged in under your own credentials.\*\****