

Appendix B: Molecular Areas Map

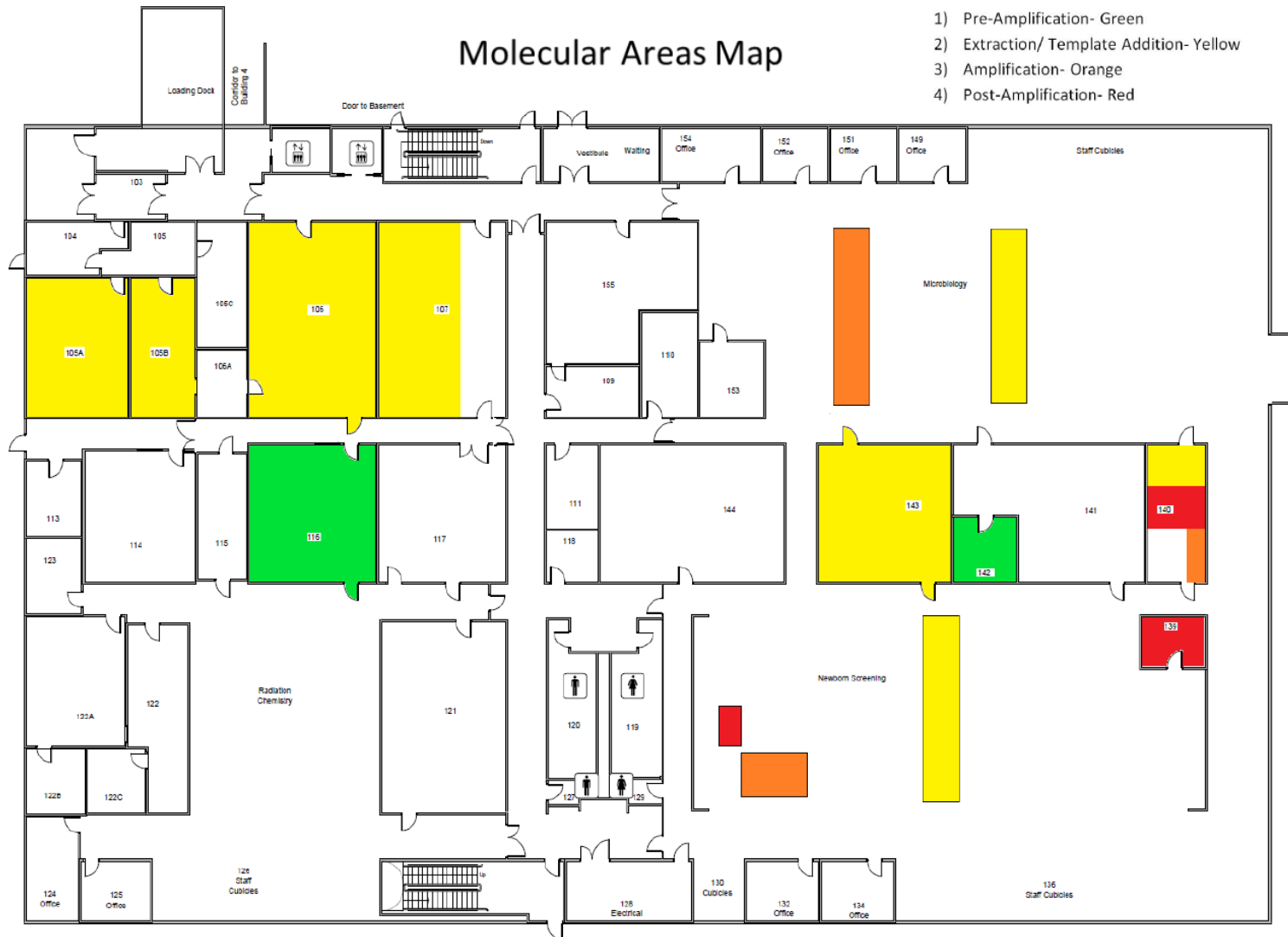

Appendix D- G: Unidirectional Workflow signs

Pre-Amplification / Assay Set-up

CLEAN Area

No samples, lysates, extraction products, or amplification products (amplicons) are permitted.

All supplies, reagents and PPE stored in this room are for dedicated use only. Do not use materials stored where amplification or post-amplification activities are conducted.

Decontaminate dead air boxes before and after use as directed in SOPs.

Extraction / Template Addition

CLEAN Area

No PCR products (amplicons) are permitted.

All supplies, reagents and PPE stored in this room are for dedicated use only. Do not use materials stored where amplification or post-amplification activities are conducted.

Decontaminate BSCs and dead air boxes before and after use as directed in SOPs.

Amplification

Contaminated Area

Gloves Only

Remove PPE and wash your hands before exiting the area.

All supplies, reagents and PPE stored in this area are for dedicated use only. They should not be removed for use in any pre-amplification area.

Post Amplification

Contaminated Area

Remove PPE and wash your hands before exiting the room.

All supplies, reagents and PPE stored in this room are for dedicated use only. They should not be removed for use in any cleaner areas.

Decontaminate work areas and dead air boxes before and after use as directed in SOPs.