



BSL- 3 Fire Emergency Evacuation Protocol

What I Need To Know...

- 3 goals in effectively managing an emergency evacuation from the BSL-3
 1. Protect individuals directly affected
 2. Prevent exposure of other staff members
 3. Protect the facility outside the BSL-3



What I Need To Do...

- ✘ Place any infectious agents inside the BSC
- ✘ Lower the sash of the BSC and leave the blower running
- ✘ Exit the BSL-3 through the gowning room (room 104 door)

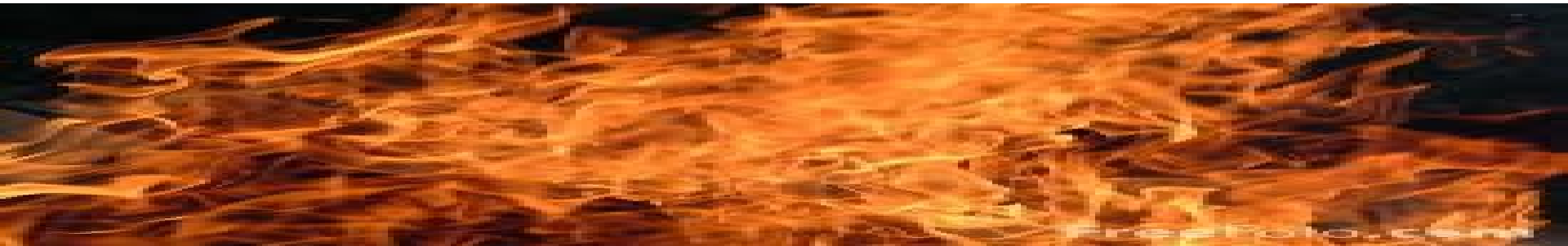

Where I Need To Go...

- ✘ Proceed to the emergency evacuation 'hot zone' external to the building.

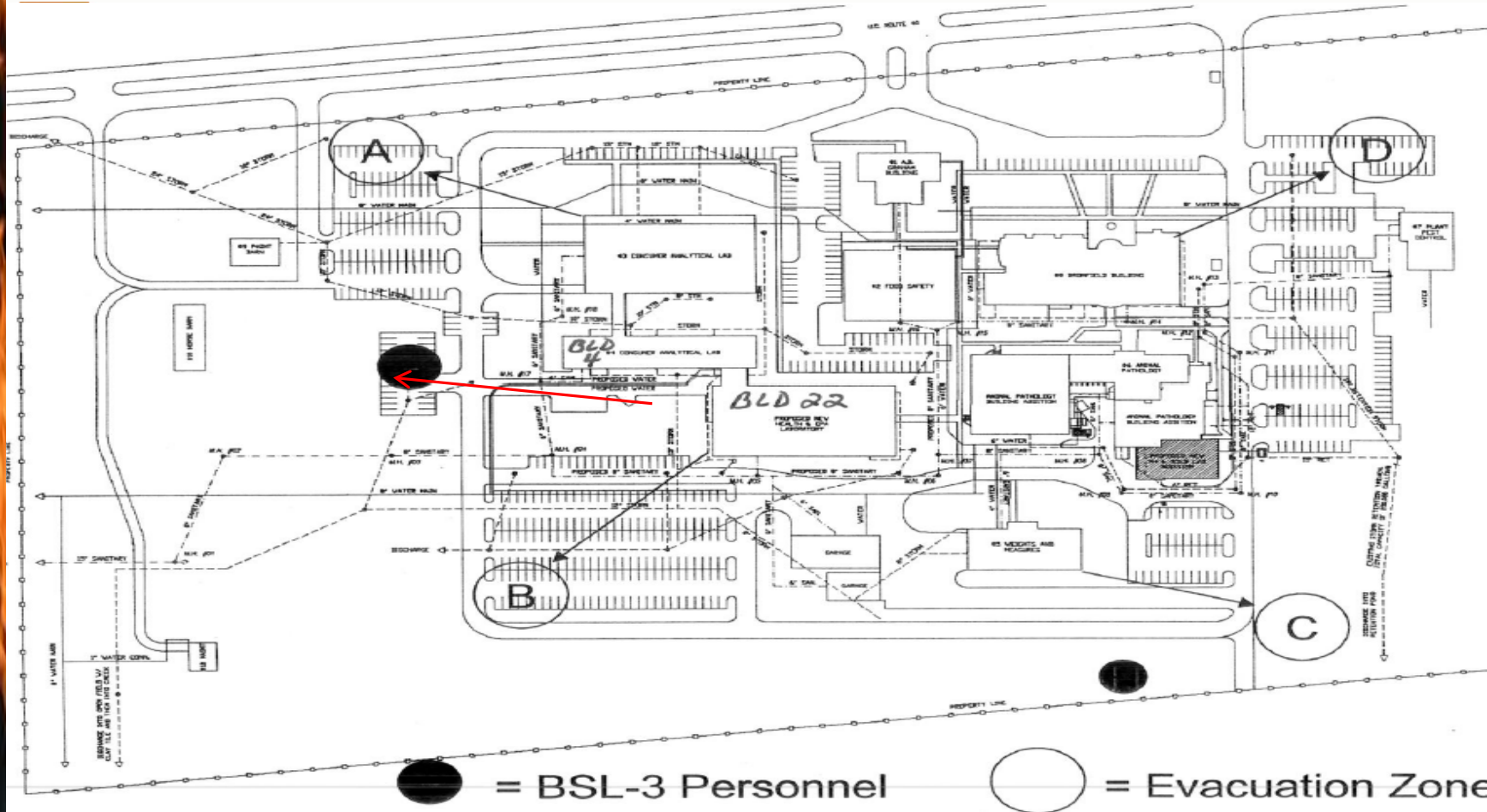

Who Do I Inform...

- ✘ Notify supervision of status of select agents, infectious agents, or hazardous materials in use
- ✘ Re-enter only after approval from supervision if facility is damaged
- ✘ Account for status of agents in activity log and perform a Select agent Inventory with the PI or lead scientist.



Please take the quiz online: Passing grade is 80%

Questions?

Please send an email to:

Eric St Germain, BT Coordinator

Steve York, RO, LSO

Tammy Bannerman, ARO

Kevin Sohner, ARO

Larry King, PI