

BSL 3 Tornado Drill Training

By Eric St Germain



BSL 3 Tornado Drill Training

- **Emergency:**
 - Secure any select agents or infectious agents by placing inside the BSC and lower the sash to ‘closed height’. Select agents in refrigerators, freezers or incubators are to be left in place.
 - Leave the BSC blower running to provide continued exhaust of the cabinet. The BSC will continue to move air out of the lab area adding a safety margin for work in progress within BSC.



BSL 3 Tornado Drill Training

- **Emergency: Insufficient notice to evacuate- Shelter in Place**
 - Move to Room 105, do not remain in Room 104 or 105A as these rooms have external walls.
 - If wearing PAPR, remain under respiratory protection.
 - Provided no damage to building and immediate danger is past, proceed with evacuation of BSL3
- **After the tornado**
 - If building is damaged so that total evacuation is required, evacuate and proceed to emergency evacuation “hot zone” external to building.



BSL 3 Tornado Drill Training

- **Emergency:** Insufficient notice to evacuate- Shelter in Place

- Move to Room 105, do not remain in Room 104 or 105A as these rooms have external walls.
- If wearing PAPR, remain under respiratory protection.
- Provided no damage to building and immediate danger is past, proceed with evacuation of BSL3



BSL 3 Tornado Drill Training

- After the tornado
 - If building is damaged so that total evacuation is required, evacuate and proceed to emergency evacuation “hot zone” external to building.

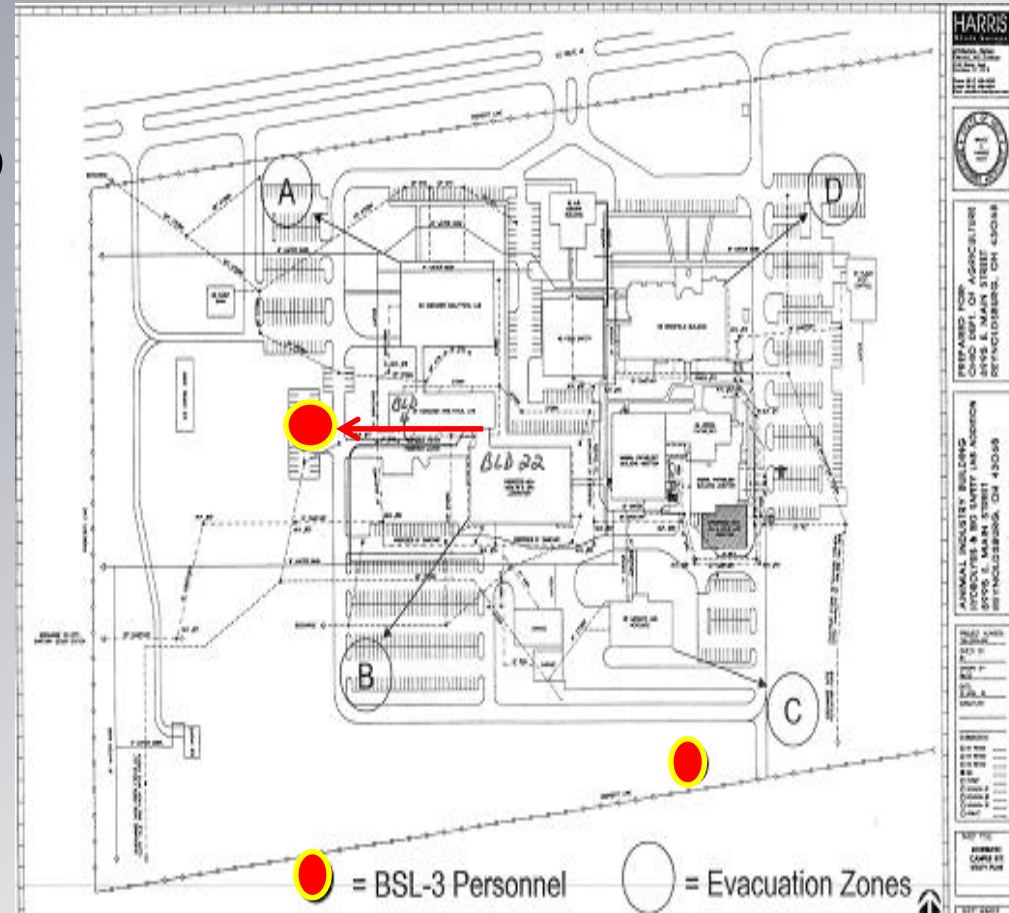

BSL 3 Tornado Drill Training

- **Emergency: Sufficient notice to evacuate**
 - Evacuate BSL3 suite following normal exit protocol and proceed to designated 'Tornado Evacuation Area' in basement of building 4.
 - Upon arrival at the basement, gather in your section's designated area as marked by signage and report to nearest Floor Warden taking role. Since there will be a lot of people in an enclosed area, keep conversation and noise to a minimum so the Floor Wardens can communicate with you and each other.



BSL 3 Tornado Drill Training

- At the first opportunity, notify supervision of the status of any select agents or infectious agents that were in use at the time of evacuation. This information may be needed if there is a fire or other emergency to assist and protect first responders.



BSL 3 Tornado Drill Training

- **Re-entry following evacuation:**
 - Respiratory protection required
- **Facility undamaged**
 - immediate re-entry allowed
 - With the lead scientist or PI account for and document the activity log status of all select agents/infectious agents and notify RO/ARO of findings.
- **Facility damaged**
 - re-enter only upon approval of supervision
 - With the lead scientist or PI account for and document the activity log status of all select agents/infectious agents and notify RO/ARO of findings.



BSL 3 Tornado Drill Training

Please take the quiz online: Passing grade is 80%

Questions?

Please send an email to

Eric St Germain, BT Coordinator

Beth Kolp, LSO

Tammy Bannerman, ARO

Larry King, PI

Kevin Sohner, RO

